

High Power Infrared Emitter For IR Reflow

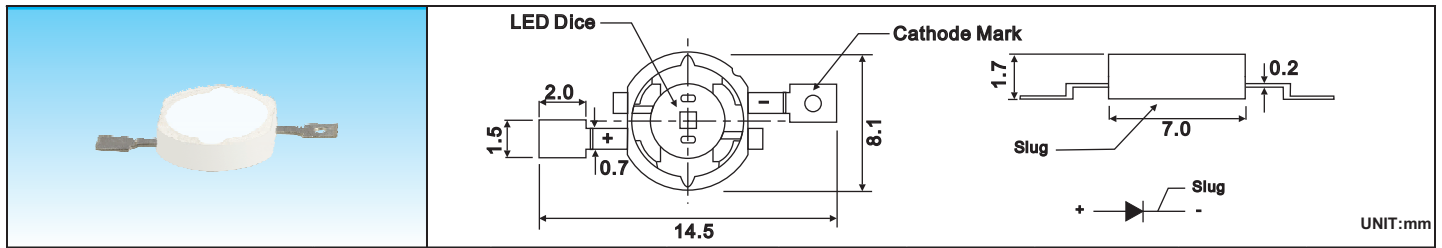

Ta=25°C

Device No	Wavelength	Lens Color	Forward Voltage		Radiant Output Power (mw/sr)			View Angle 2θ1/2
	λp(nm)		Typ(V)	IF(mA)	Minimum	Typical	IF(mA)	



HIRPR8C-1G	850	White	1.6	1000	90.0	160	1000	110
HIRPR8C-1Gb	850	diffused	1.7	500	50.0	80.0	500	

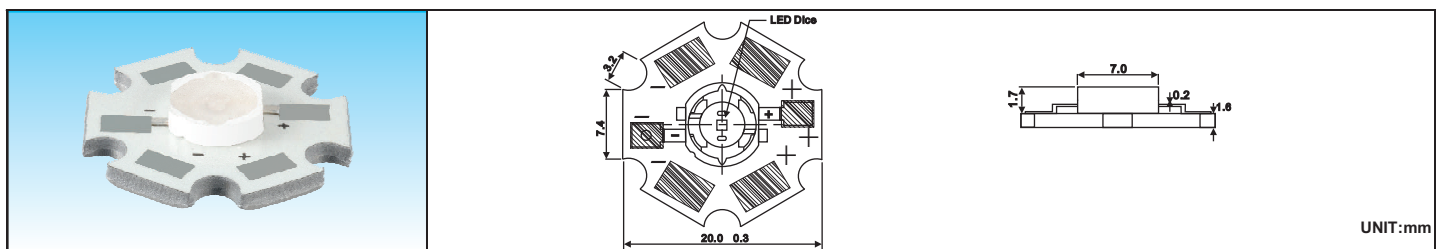

HIRPR8C-1G/WPCB	850	White	1.6	1000	90.0	160	1000	110
HIRPR8C-1Gb/WPCB	850	diffused	1.7	500	50.0	80.0	500	